

Indoor detector for lighting

ref. 500132



A - SAFETY INSTRUCTIONS

A1 - OPERATING PRECAUTIONS

- Do not allow children to operate the product.
- This product is designed exclusively for indoor use.
- This product is designed to be used with devices from the Thomson Connected Home range: remote-controlled socket, Thombox, etc.

A2 - SERVICING AND CLEANING

- Use a soft, slightly damp cloth to clean your product.
- Do not use abrasive or corrosive substances.
- Do not spray any products directly onto the unit.

A3 - RECYCLING



It is forbidden to throw used batteries into the dustbin. Batteries/accumulators containing harmful substances are marked with symbols (shown opposite) which indicate that they cannot be thrown away as ordinary waste. The corresponding heavy metal designations are as follows: Cd = cadmium, Hg = mercury, Pb = lead. You can dispose of these batteries/accumulators at local recycling amenities (centres for sorting recyclable materials) which are required to accept them. Keep batteries/button cells/accumulators out of reach of children and store them in a safe place not accessible to them as they could be swallowed by children or domestic animals. May be fatal if swallowed. In the event that a battery is swallowed, consult a doctor or go to A&E immediately. Never short-circuit the batteries, and do not burn or recharge them as they may explode!



This logo denotes that devices which are no longer in use must not be disposed of as household waste as they are likely to contain hazardous substances which are dangerous to both health and the environment. Return the equipment to your local distributor or use the recycling collection service provided by your local council.

B - PRODUCT DESCRIPTION

B1 - DETECTOR

Front

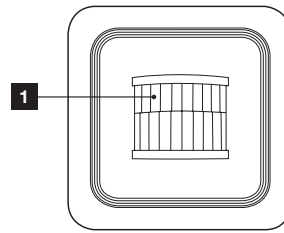

1 Detection window

Interior view

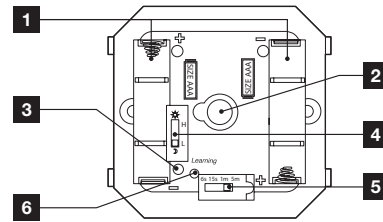

- | | |
|---|--|
| 1 | Battery compartment (batteries not included) |
| 2 | Motion and light sensors |
| 3 | Pairing button |
| 4 | Threshold detector |
| 5 | Duration selector |
| 6 | System on indicator light |

C - ABOUT THE THOMBOX CONCEPT

The Thombox is a home automation unit which connects to your ADSL modem (Freebox, Livebox, etc.) and enables you to manage your home security from any location as if you were using the actual alarm control unit at home or remotely. The system also allows you to control your comfort accessories (lighting, etc.), openers (shutter motors, garage doors, etc.) and manage your energy use (heating and electricity consumption) with just a few clicks on a computer, touchscreen tablet or smartphone, from anywhere in the world with an internet connection.

To enable the above and be able to create scenes (action sequences) which will simplify your day-to-day life, you need to register your Thombox (only when you first install it), and pair your ARW technology compatible accessories with it.

The Thombox is completely modular and there is no limit to the number of accessories it can control.

D - INSTALLATION

D1 - DETECTOR

Remove the front of the detector using a thin tool.

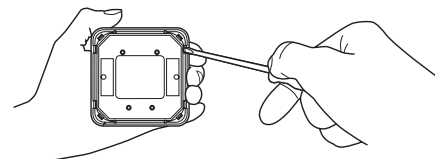

Attach the mount using double-sided tape or screws and wall plugs which are appropriate to the type of wall.

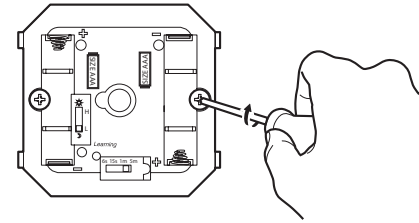

Insert 2 LR03 AAA batteries, ensuring that you comply with the indicated polarity.

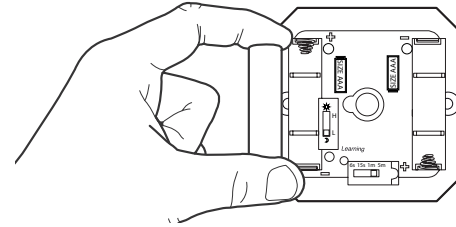

E - CONFIGURATION

E1 - PROGRAMMING

Your indoor detector can be paired with other devices from the Thomson Connected Home range: remote-controlled socket, Thombox, etc.

- To pair the detector with another device, remove the front cover, then use a thin tool to hold down the pairing button for 3 seconds.

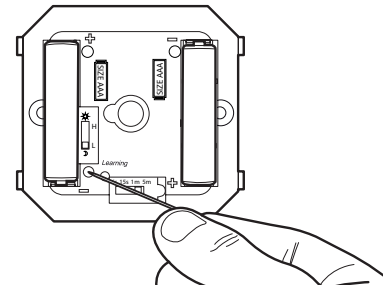

- Then place the device to be controlled into pairing mode. Refer to the device's user guide to find out how to do this.
- Notes:** You can pair up to five devices.

E2 - SETTING THE THRESHOLD AND THE LIGHTING DURATION

- Use the selector / to alter the light levels which trigger the sensor (choose from 4 positions). In the position, the detector will trigger even in broad daylight. In the position, the detector will only trigger in almost complete darkness.
- Use the 6s/15s/1mn/5mn selector to choose the length of time before the device controlled is switched off. This length of time corresponds to the amount of time that a light will be on, for example.

F - USING THE PRODUCT

F1 - USING THE PRODUCT WITH ANY DEVICE FROM THE THOMSON CONNECTED HOME RANGE

- When the ambient light levels fall below the threshold specified to the detector (for example night), if movement is detected, an 'on' command is sent. At the end of the specified time, an 'off' command is sent. Please refer to the user guide of the relevant devices to understand what the 'start' and 'stop' commands do (CMV quick speed, turning on a light, etc.).

F2 - USING THE PRODUCT WITH THE THOMBOX

- When you pair your indoor detector with a Thombox, it does not appear in the dashboard but is available in the rule creator in the 'Control' section. You can then create rules which you can trigger based on motion detected outside.

F3 - REMOVAL OF ALL INDOOR MOTION DETECTION DEVICES

- To remove all of the devices controlled by the detector, hold the pairing button for 3 seconds using a thin-tipped tool. The red indicator will begin to flash.
- Release the button, then immediately hold the pairing button for 5 seconds. Holding the pairing button a second time will stop the flashing, then make it start once again.

All of the controlled devices will then be cleared from the indoor motion detector's memory.

F4 - REPLACING THE DETECTOR BATTERIES

If you notice that the range of your detector is decreasing, the battery should be replaced. Under normal conditions, battery life is approximately one year.

G - TECHNICAL AND LEGAL INFORMATION

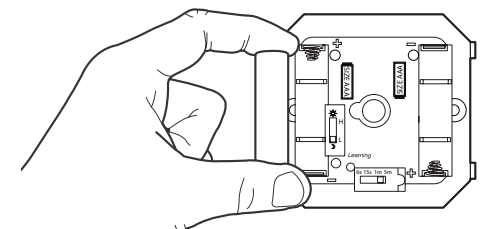

G1 - TECHNICAL CHARACTERISTICS

- Radio frequency: 868.3MHz, ARW protocol
- Radio range: up to 150m, open air range*
- Power supply: 2 LR03 AAA 3V DC batteries (not included)
- Maximum number of devices in memory: 5
- Operating temperature: 0°C to 40°C, indoor use only

*The indicated radio range refers to the open air range, i.e. no obstacles between the receiver and the transmitter. Any obstacle or disturbance will reduce this range.

G2 - WARRANTY

This product is guaranteed for parts and labour for 2 years from the date of purchase. It is essential to retain the proof of purchase for the duration of the warranty period.

The guarantee does not cover damage caused by knocks or accidents. This product must not be opened or repaired by any persons not employed by AVIDSEN except to insert or replace the batteries. So-called consumables, such as the batteries, are not covered by the warranty.

G3 - ASSISTANCE AND ADVICE

- If, in spite of the care we have taken in designing our products and drafting these instructions, you do encounter difficulties when installing your product or you have any questions, we urge you to contact one of our specialists who will be glad to help.
- If you encounter operating problems during the installation or a few days afterwards, it is essential that you are in front of your installation when contacting us, so that one of our technicians can diagnose the source of the problem, as it will probably be the result of a setting that is incorrect or an installation that is not to specification. If the problem is caused by the product itself, the technician will give you an RMA number so that you can return the unit to the shop.
Without this RMA number, the shop may refuse to exchange your product.

Need help when setting up or installing your Thombox, or when pairing your accessories from the Thomson Connected Home range?

Contact our after-sales service technicians on:

Tel: + 33 (0)892 701 369

(Audiotel: €0,337/min incl. VAT)

Monday to Friday, 9 AM to 12 PM and 2 PM to 6 PM.

G4 - DECLARATION OF CONFORMITY

With the R&TTE directive

AVIDSEN hereby declares that the following equipment: Indoor detector for lighting 500132

Complies with the R&TTE 1999/5/CE directive and that its conformity has been assessed pursuant to the applicable standards in force:

EN62479:2010

EN301489-1 V1.9.2

EN301489-3 V1.4.1

EN300220-2 V2.4.1

Signed at Chambray les Tours on 13/11/2014 by

Alexandre
Chaverot, CEO



Visit our website to find out more about our Thomson range at

www.thomsonbox.eu

THOMSON is a **TECHNICOLOR S.A.** brand used under licence by:

Avidsen France S.A.S.- 32, rue Augustin Fresnel
37170 Chambray les Tours - France